

5樓平面圖

5/F FLOOR PLAN



備註 : 1. 水平鱗片在上方只適用於其相關減音窗(上懸式)之樓層, 如圖所示。
 2. 平面圖所列之數字為以毫米標示之建築結構尺寸。

Notes : 1. Horizontal Fin Above is only applicable on the same floor of corresponding acoustic window (top hung type) as shown on plan.
 2. The dimensions in floor plans are all structural dimensions in millimeter.

6樓平面圖

6/F FLOOR PLAN

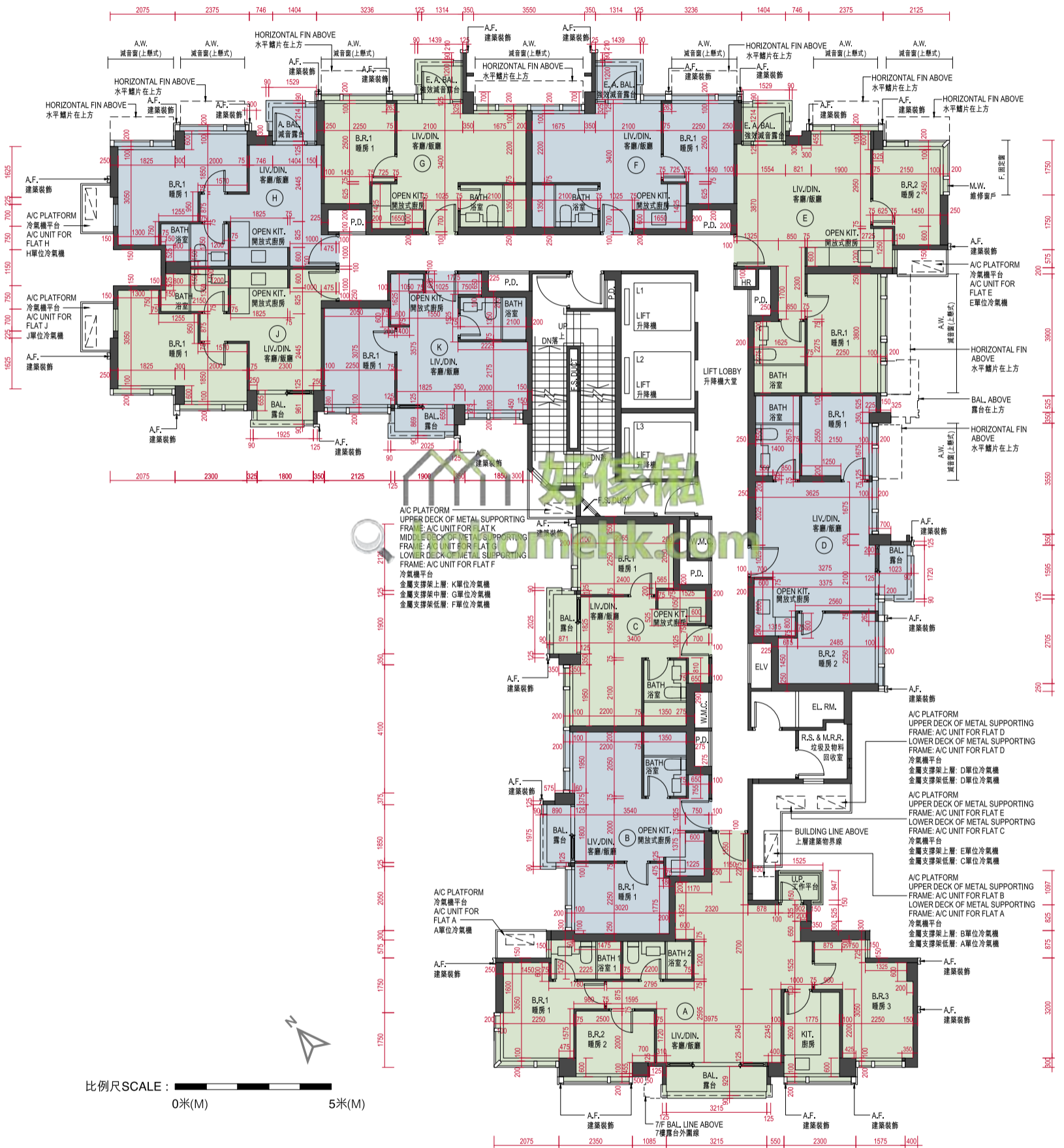

備註 : 1. 水平鱗片在上方只適用於其相關減音窗(上懸式)之樓層, 如圖所示。
 2. 平面圖所列之數字為以毫米標示之建築結構尺寸。

Notes : 1. Horizontal Fin Above is only applicable on the same floor of corresponding acoustic window (top hung type) as shown on plan.
 2. The dimensions in floor plans are all structural dimensions in millimeter.

7樓-12樓、15樓-23樓、25樓-33樓及35樓-36樓平面圖 7/F-12/F, 15/F-23/F, 25/F-33/F & 35/F-36/F FLOOR PLAN

J單位露台部份平面圖
(10樓-12樓、15樓-23樓、25樓-33樓及35樓-36樓)
BALCONY PART PLAN FOR FLAT J
(10/F-12/F, 15/F-23/F, 25/F-33/F & 35/F-36/F)

H單位露台部份平面圖
(10樓-12樓、15樓-23樓、25樓-33樓及35樓-36樓)
BALCONY PART PLAN FOR FLAT H
(10/F-12/F, 15/F-23/F, 25/F-33/F & 35/F-36/F)

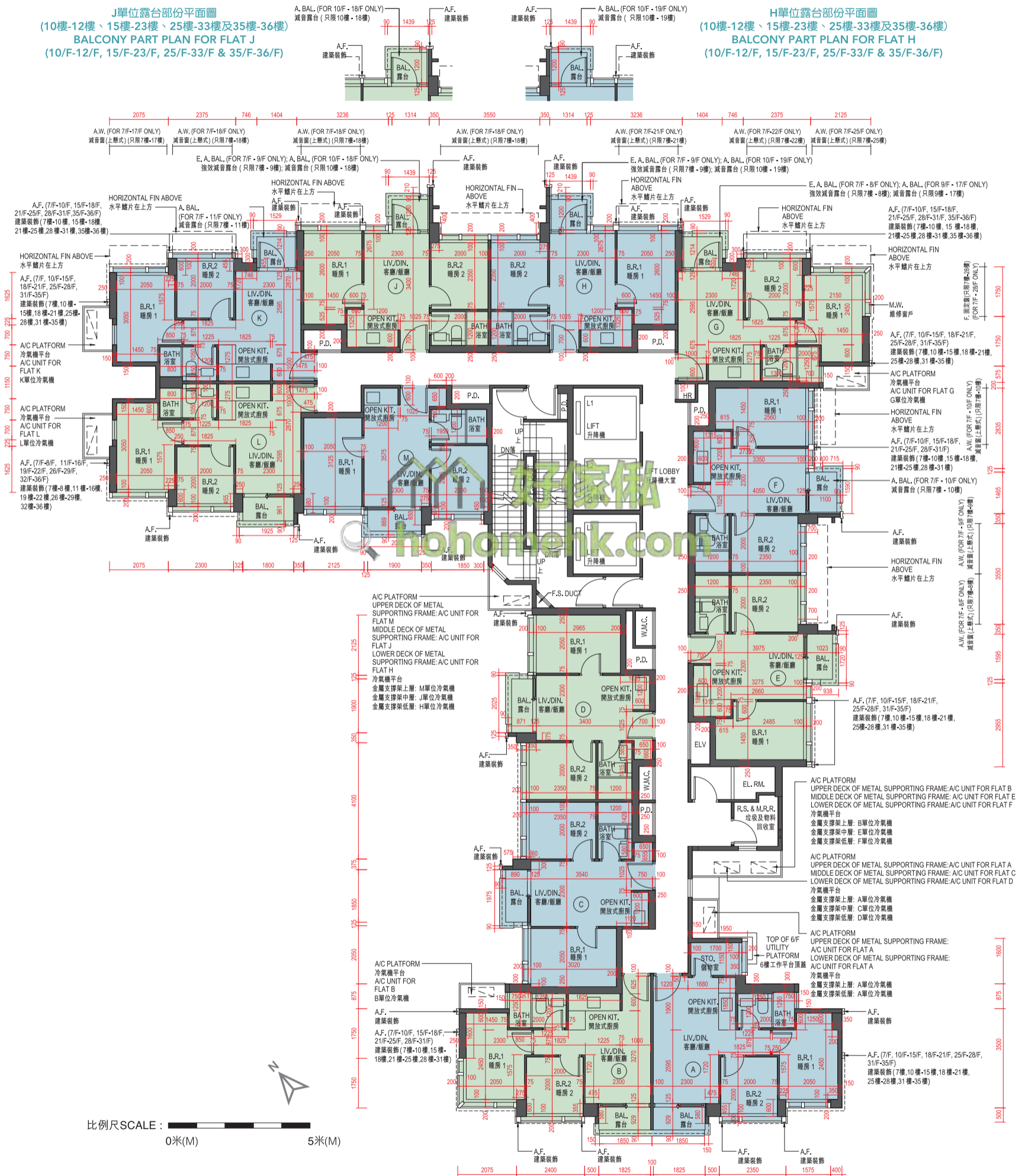

備註 : 1. 水平鱗片在上方只適用於其相關減音窗(上懸式)之樓層, 如圖所示。
2. 平面圖所列之數字為以毫米標示之建築結構尺寸。

Notes : 1. Horizontal Fin Above is only applicable on the same floor of corresponding acoustic window (top hung type) as shown on plan.
2. The dimensions in floor plans are all structural dimensions in millimeter.

37樓平面圖

37/F FLOOR PLAN



備註：平面圖所列之數字為以毫米標示之建築結構尺寸。

Note: The dimensions in floor plans are all structural dimensions in millimeter.